

# 一、竣工図面

南面

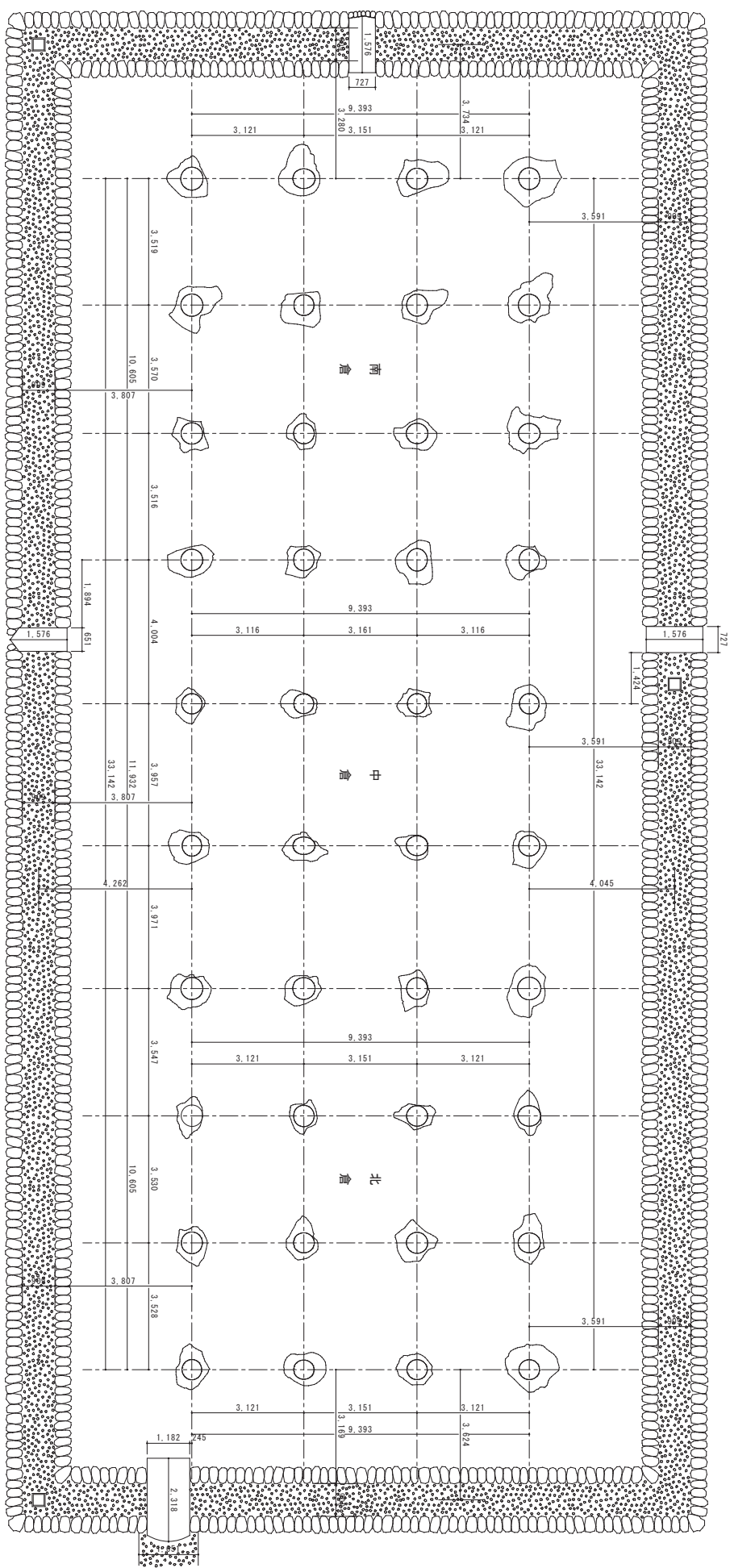

北面

西面

東面

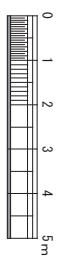

南面

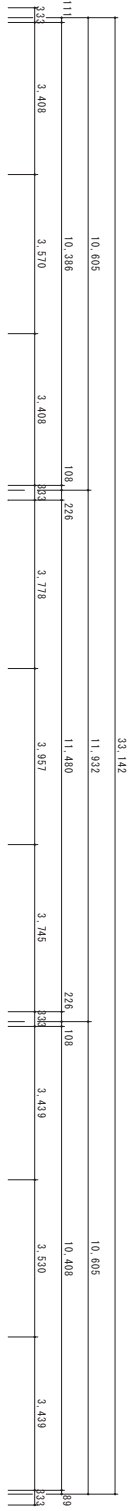
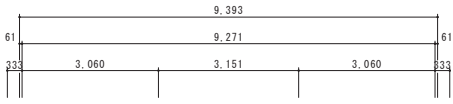

西面

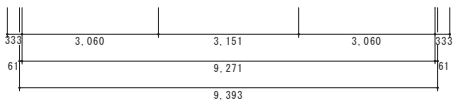
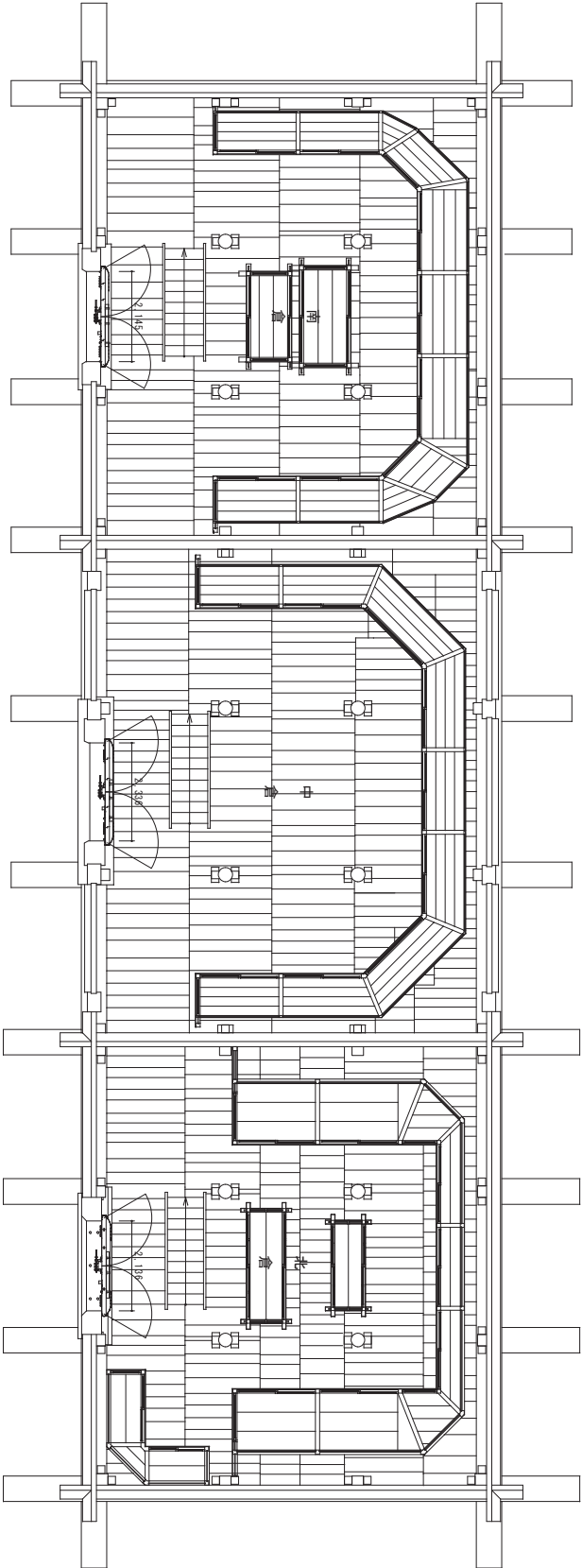

北面

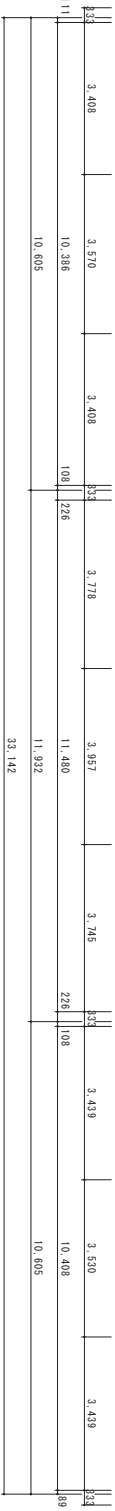

東面





東 面

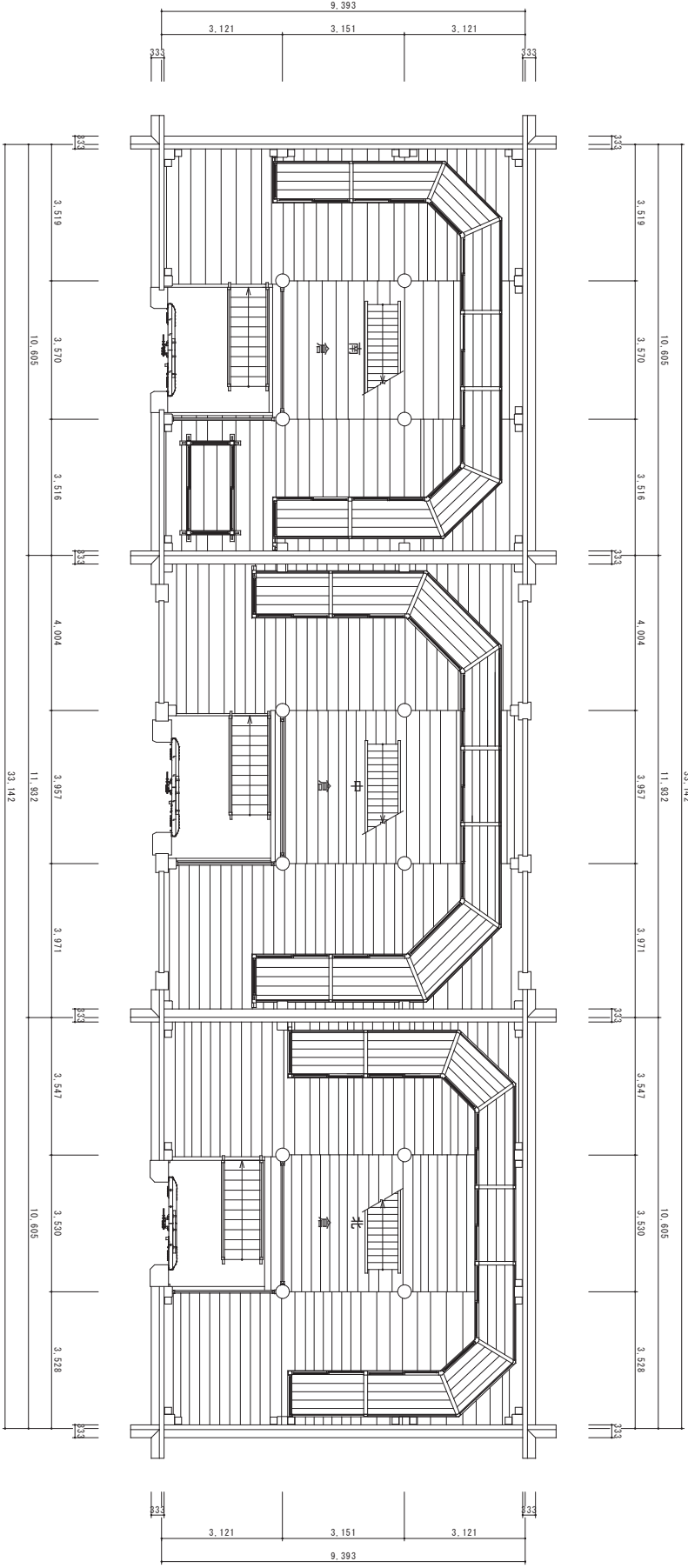

南 面

西 面

北 面

南面

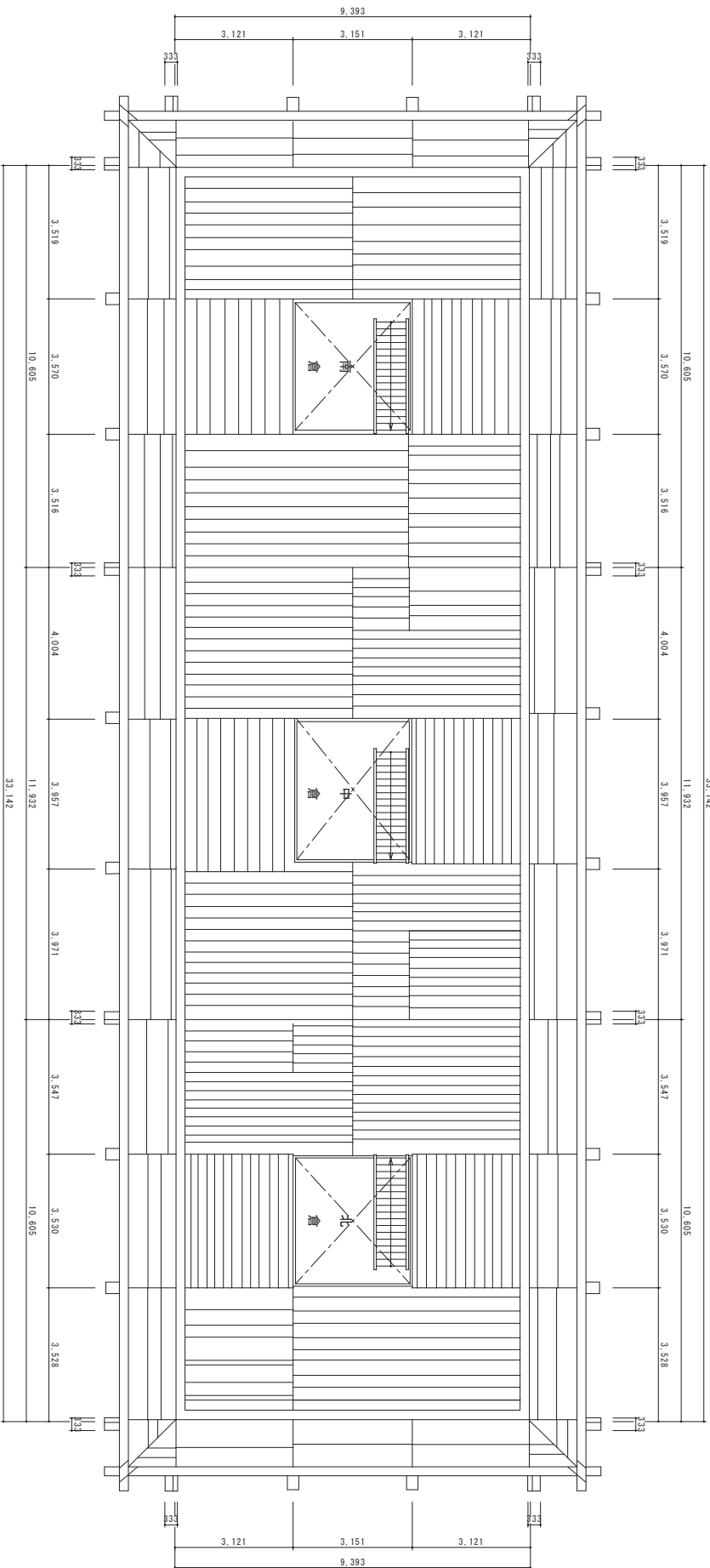

北面

西面

東面



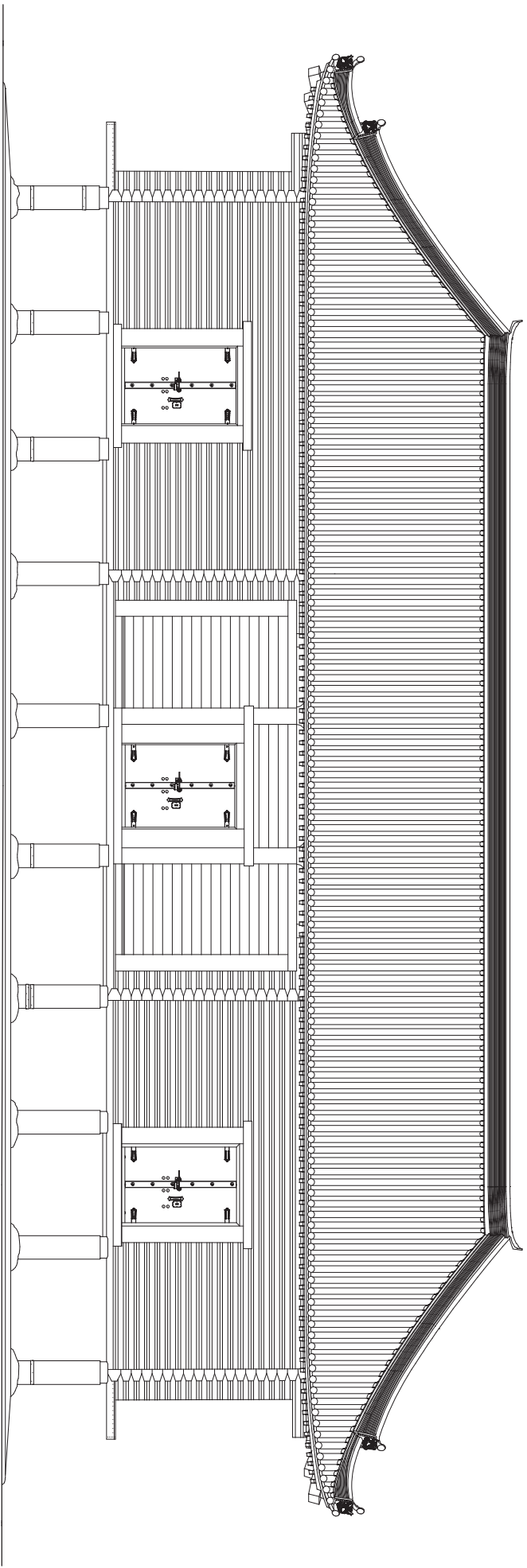

5 正倉 竣工 正面図 (東面)

6 正倉 竣工 側面図 (南面)

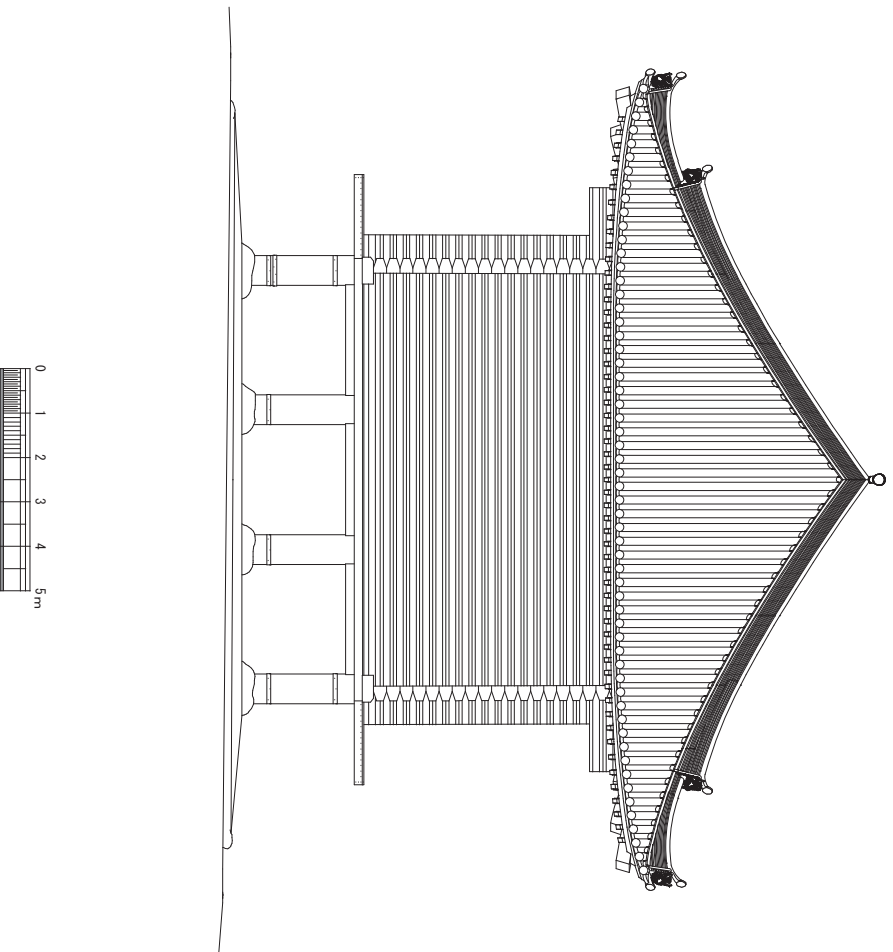

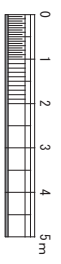
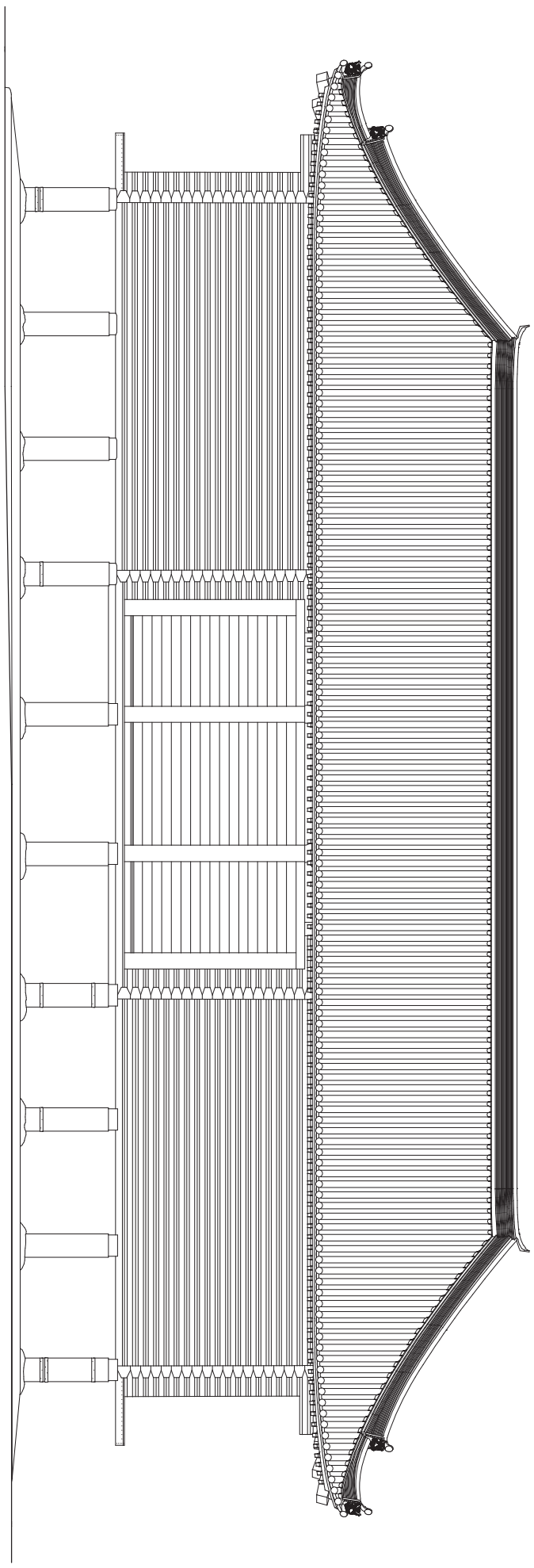

7 正倉 竣工 背面図 (西面)



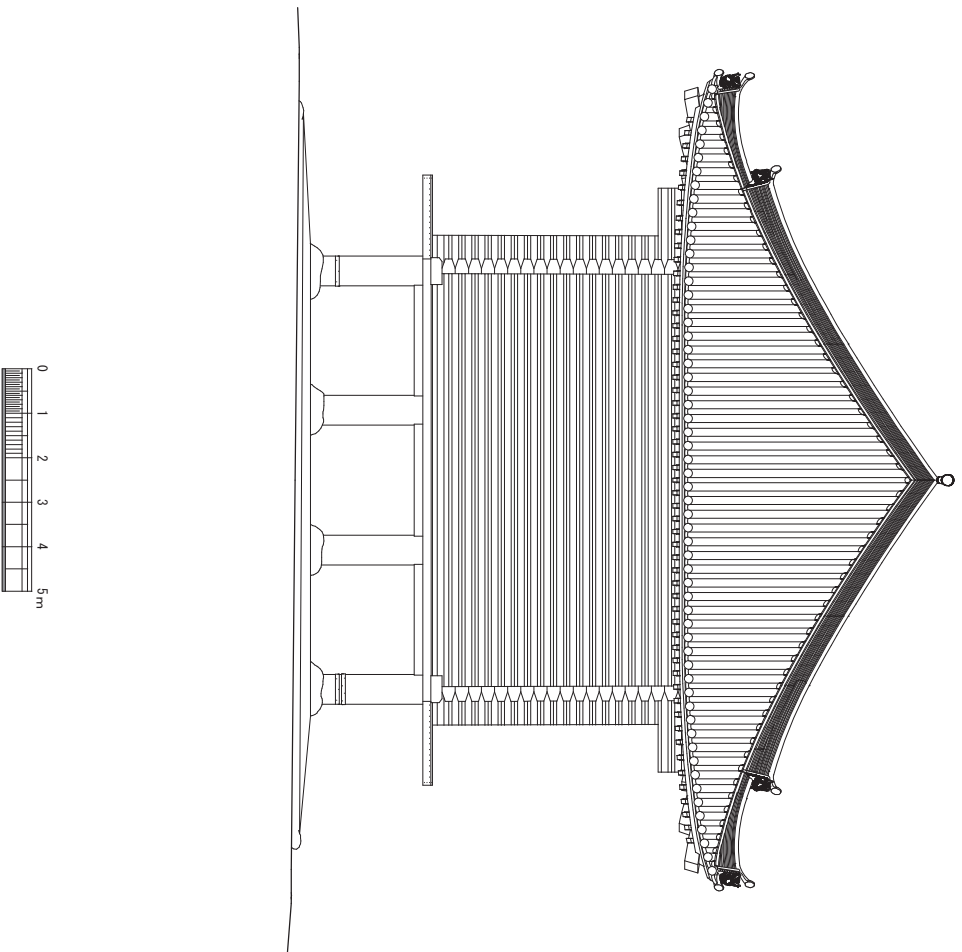

9 正倉 竣工 桁行断面図 (東向)

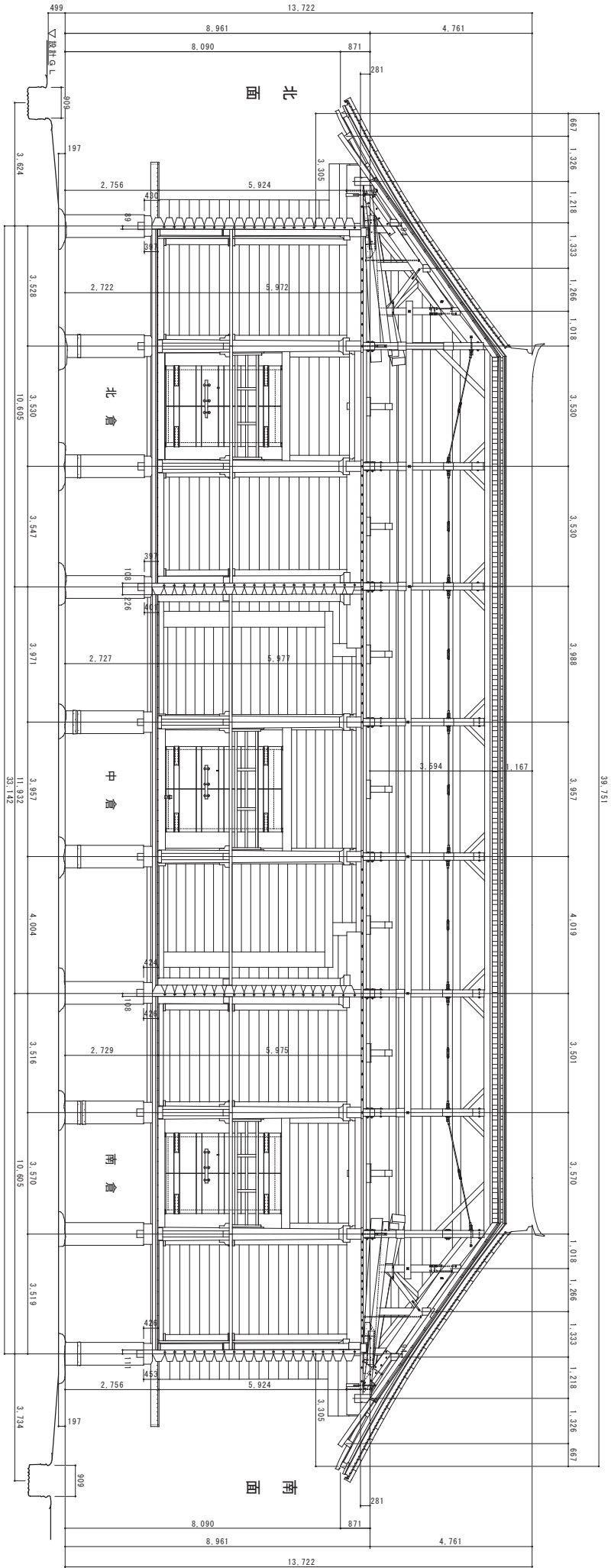

10 正倉 竣工 桁行断面図 (西向)

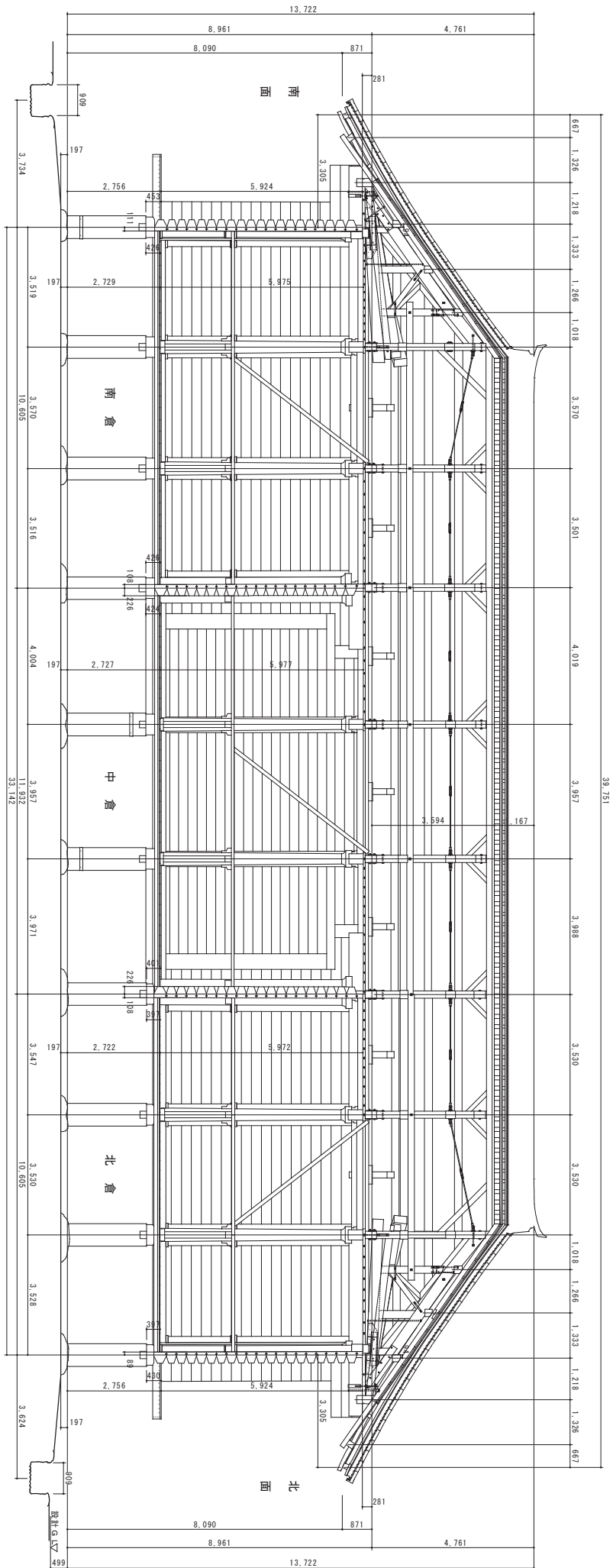

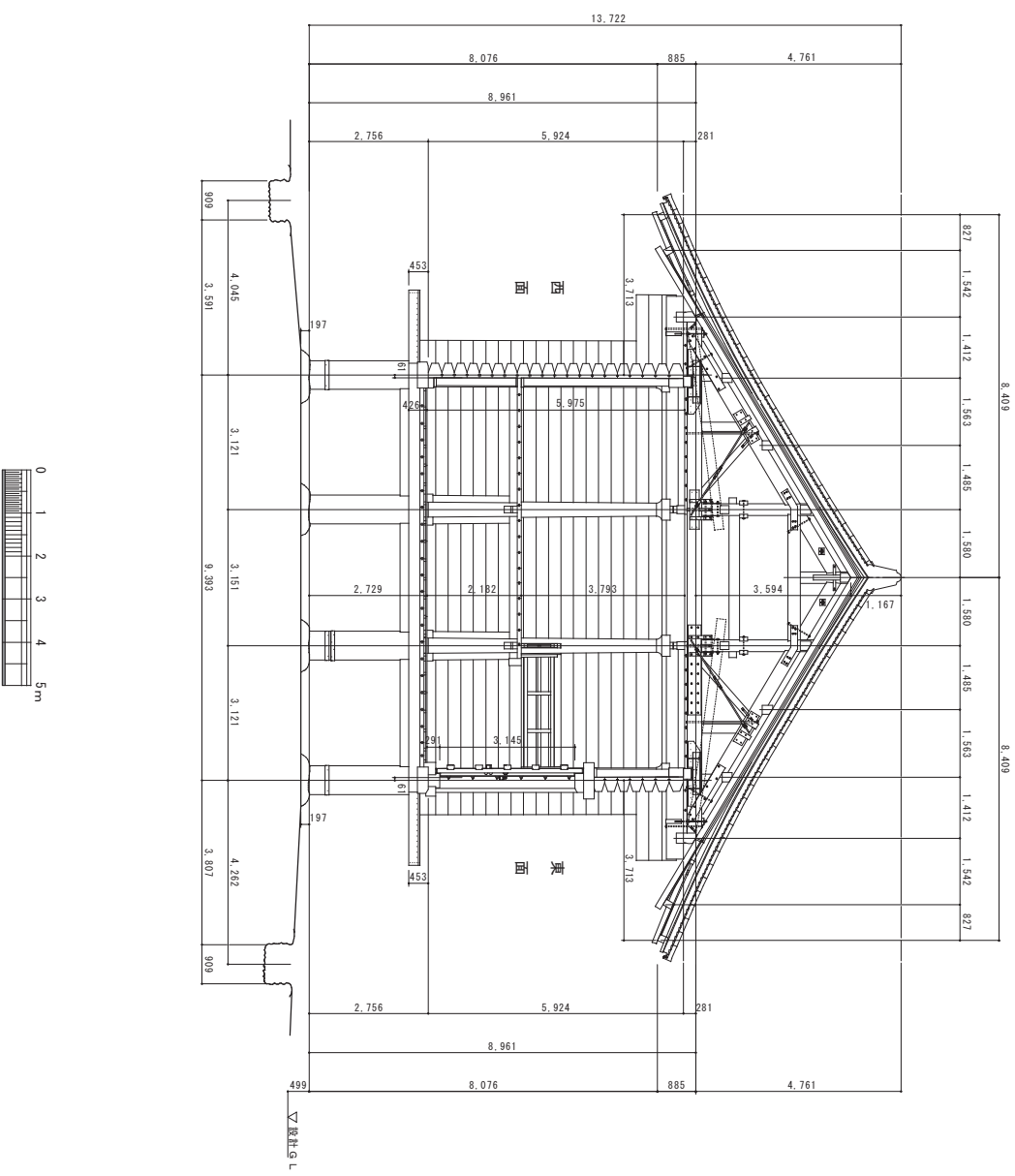

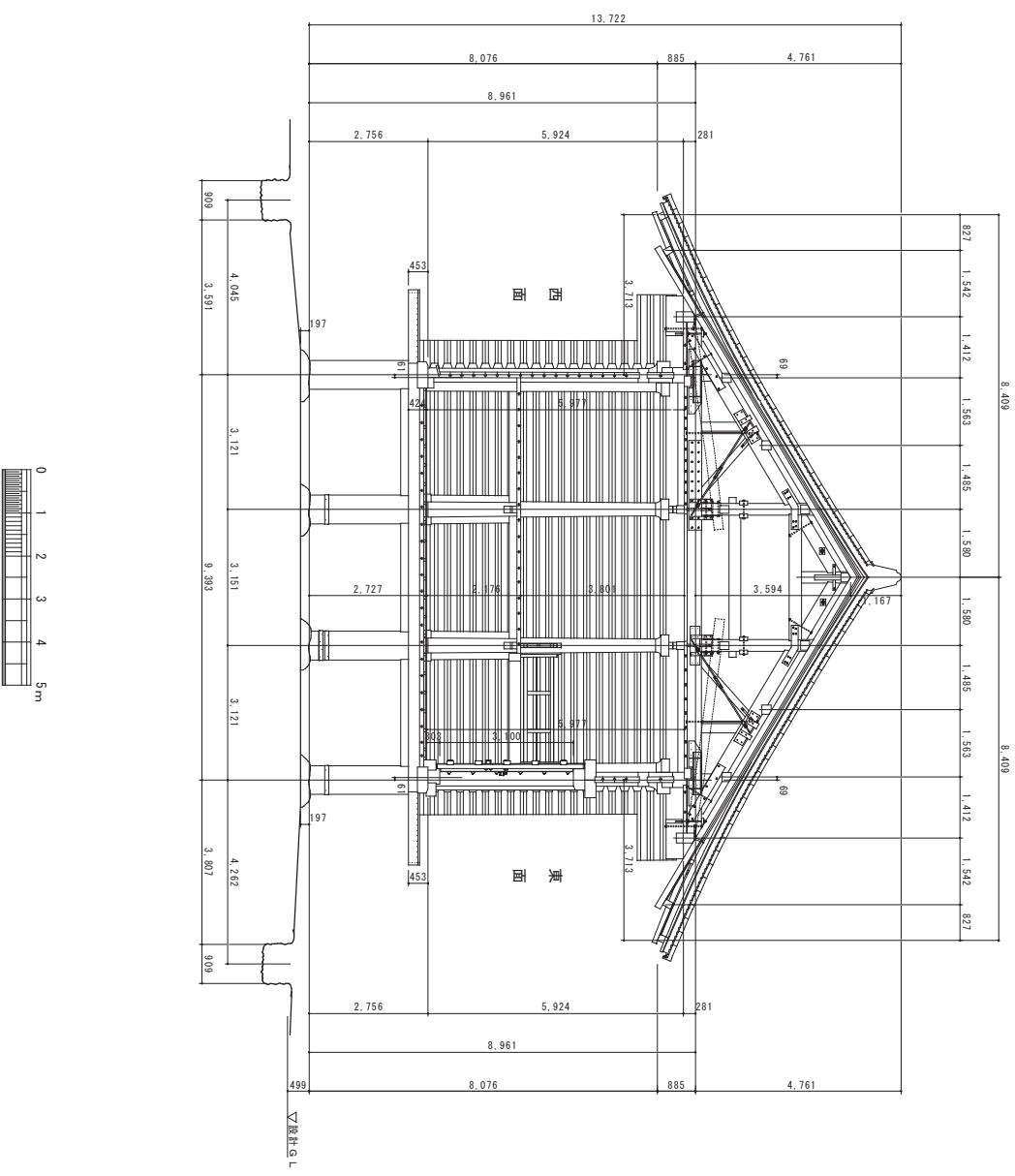

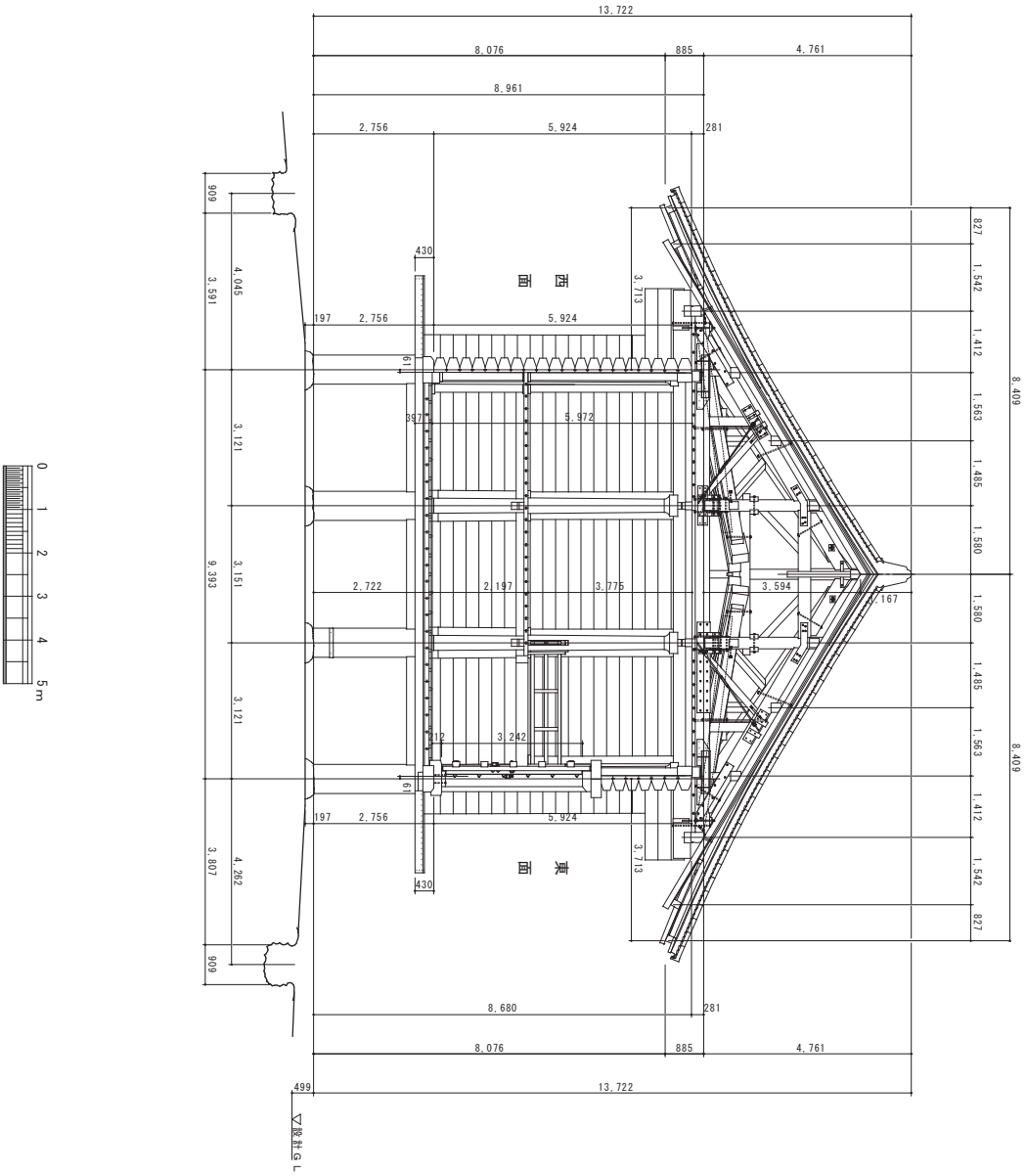

南面  
9.393

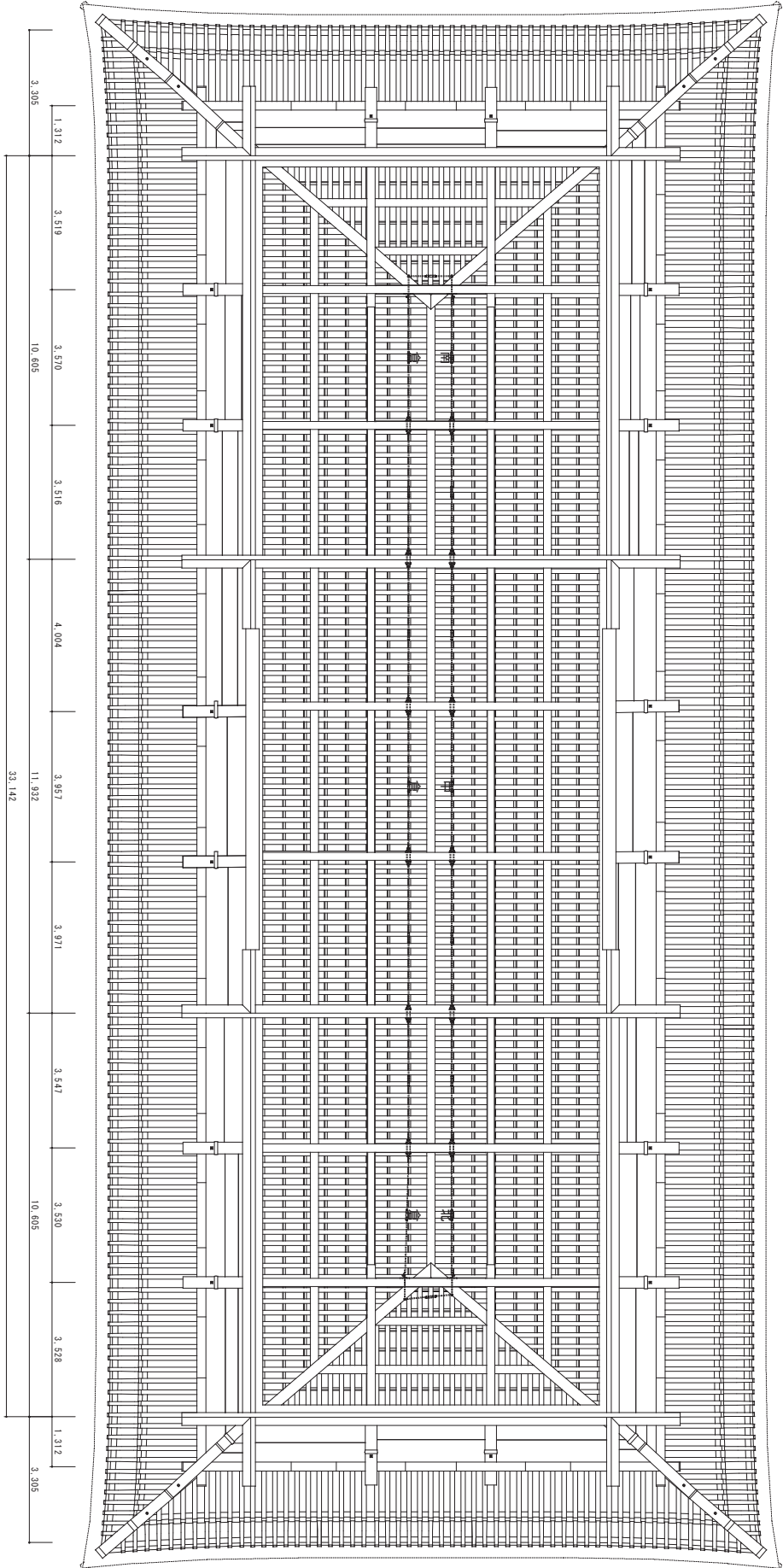
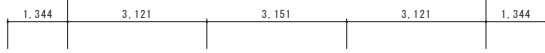

西面  
33.142

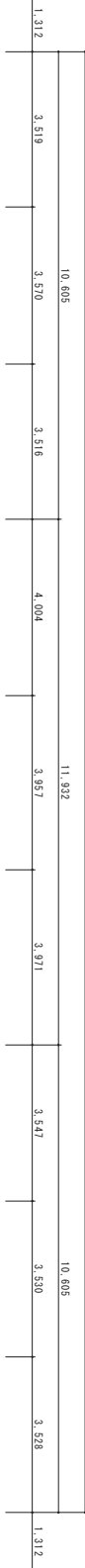

北面  
9.393

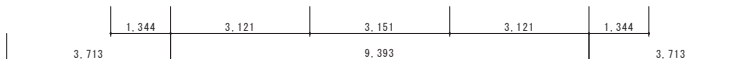

東面  
33.142

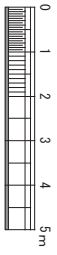

南面

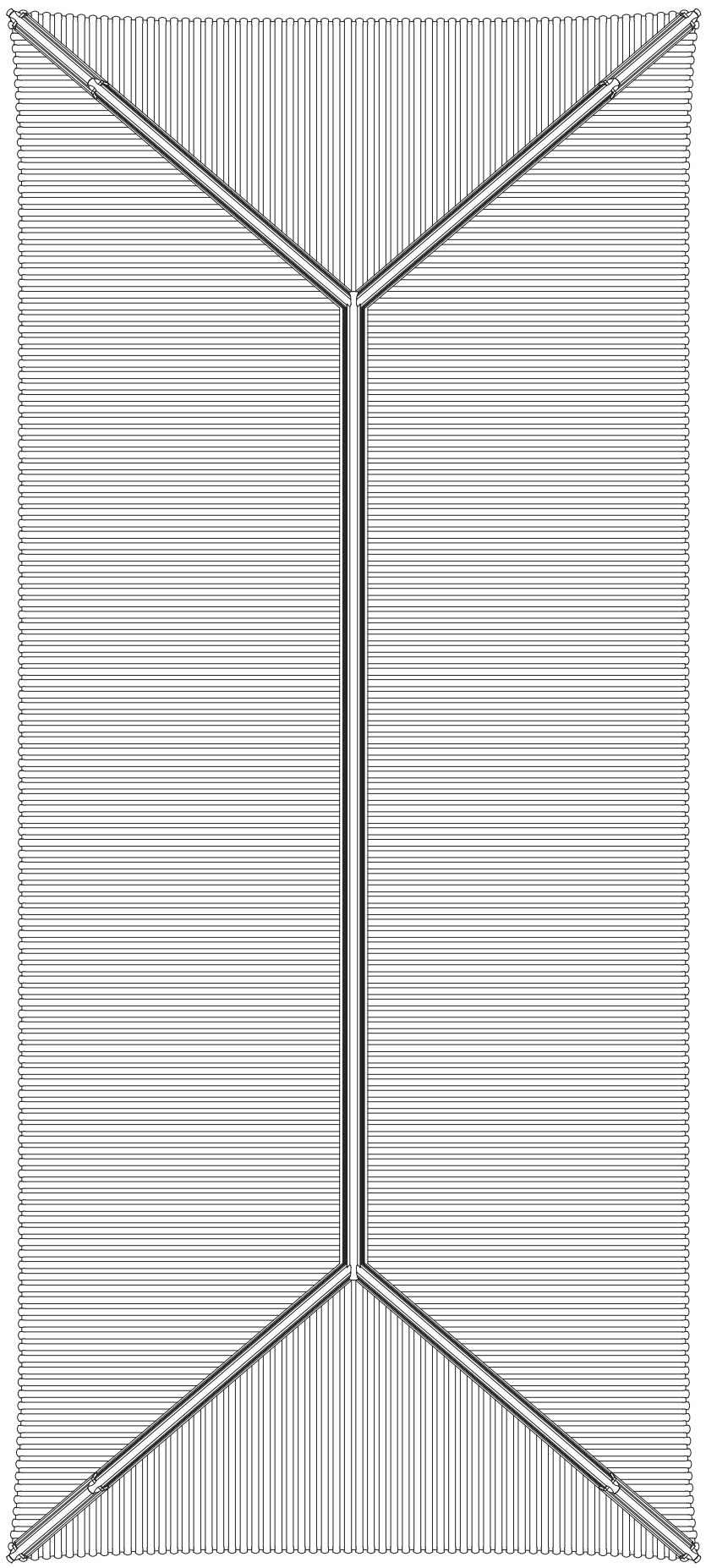

北面

西面

東面

